

STAGE 24

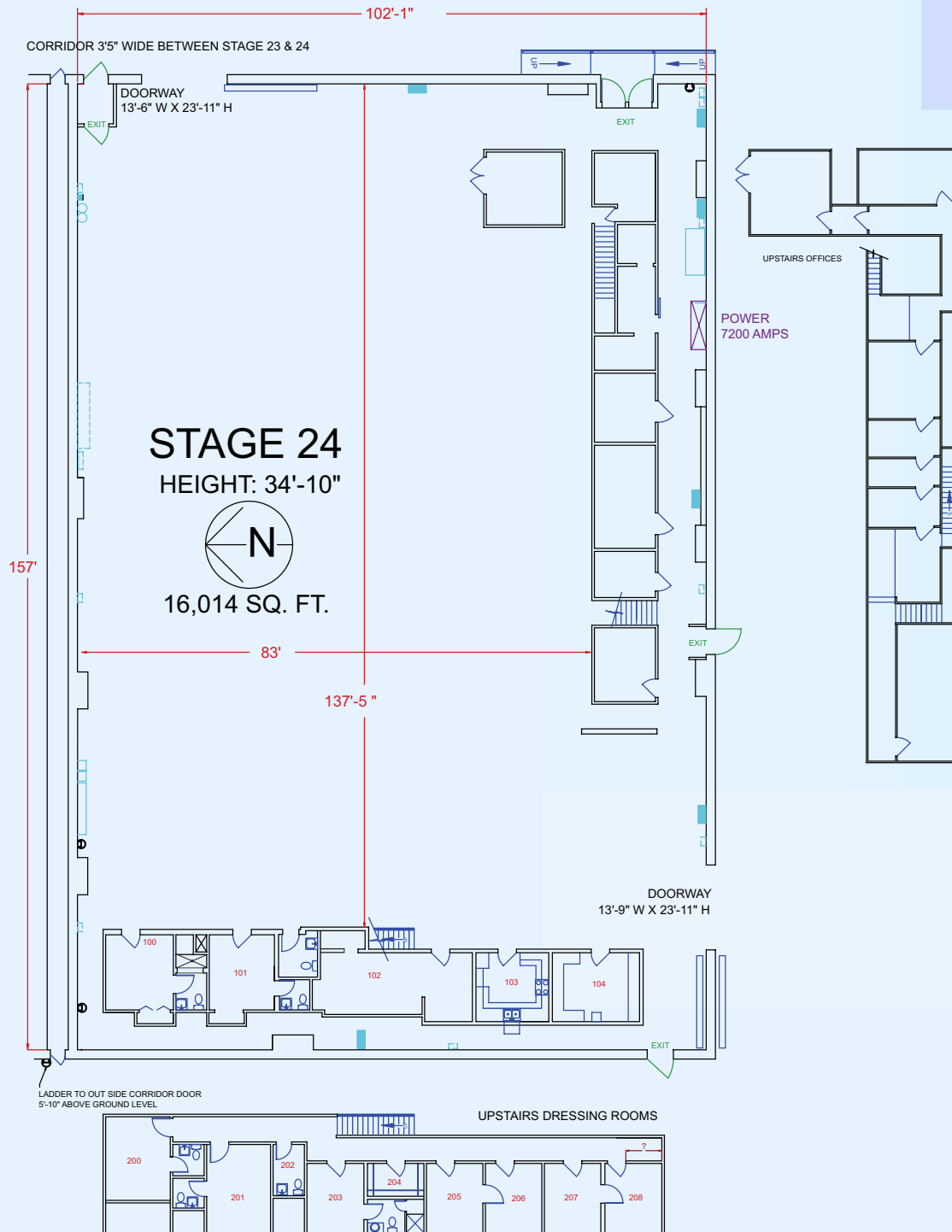

Stage Size:

102' x 157' (16,014 square feet)
Height 35'

Electrical:

- 1 power can, 7200 amps, 120/240 volts, 6 circuits.

Support Rooms on Stage:

- 9 Dressing Rooms, Prop & Craft Service Kitchens, Green Room, VIP Room, Wardrobe Space, Hair/Makeup Room, Storage & Gold Rooms, Sound Booth & Control Rooms, Additional Phones

Permanent Fall Protection:

(Horizontal Lifeline)

Air Conditioning:

Permanent Air Conditioning, 80 tons

Telcom:

- Permanent Wireless Internet
- DSL Hardline
- Fiber Optic: 24 strands multimode; 12 strands single mode (to main distribution frame)

Miscellaneous:

- Usable space 83' x 102'-5" (approximately)
- 2 stage walls painted black bottom 1/2
- Catwalks, Wooden Grid, and Steel Truss
- Floors: Raised Wooden
- Silent Air

* Stage dimensions have been rounded to nearest foot



10202 WEST WASHINGTON BOULEVARD
CULVER CITY, CALIFORNIA 90232